

MINIATURE GENERAL PURPOSE FILTERS

F07 - G1/8, G1/4

F07



Direct ported filters with high water removal efficiency
 Automatic drains supplied as standard
 High flow miniature unit
 Transparent bowl for 360° visibility

TECHNICAL DATA

Medium:

Compressed air only

Maximum inlet pressure:

10 bar

Ambient temperature:

-34°C ... +50°C

Consult our Technical Service for use below +2°C

MATERIALS

Bowl: polycarbonate to BS 6005, zinc alloy (optional)

Body: zinc alloy

Elastomers: neoprene & nitrile

Filter element: polypropylene

Port size	Flow* (dm ³ /s)	MODELS		ACCESSORIES Wall mounting bracket	SERVICE KIT Auto drain	Manual drain
		Auto drain	Manual drain			
 G 1/8 G 1/4	9			 5939-06 5939-06	 F07-KITA40 F07-KITA40	 F07-KITM40 F07-KITM40
	11,5	F07-100-A3TG F07-200-A3TG	F07-100-M3TG F07-200-M3TG			

*Typical flow with 6,3 bar inlet pressure and 0,5 bar pressure drop

OPTIONS SELECTOR

F07-★00-★ ★ ★ ★

Port size	Substitute	Threads	Substitute
1/8"	1	PTF	A
1/4"	2	ISO Rc taper	B
		ISO G parallel	G
		Bowl	Substitute
		Transparent	T
		Metal	M
		Element	Substitute
		5 µm	1
		40µm	3
		Drain	Substitute
		Automatic	A
		Manual	M

For further information



www.norgren.com/info/en6-090

FLOW CHARACTERISTICS

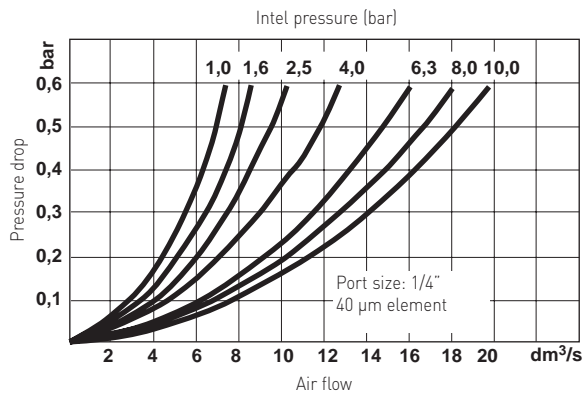

DIMENSIONS

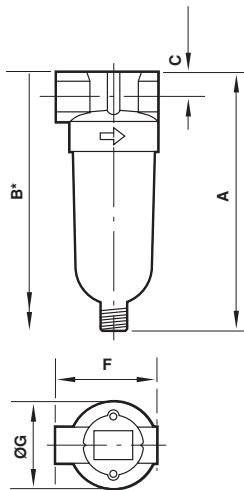

* Minimum clearance required to remove bowl

Series	Port size	Drain	A	B	C	F	Ø G	kg
F07	G1/8, G1/4	Auto	104	154	10	42	37	0,13
		Manual	108	158	10	42	37	0,13

Bracket mounting

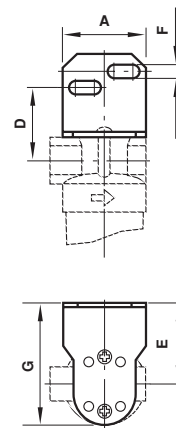

Series	Port size	A	D	E	F	G	H
F07	G1/8, G1/4	38	35	34	6	52	-